

风电系列轴承
WIND POWER BEARING

ZWZ

风电系列轴承

WIND POWER BEARING

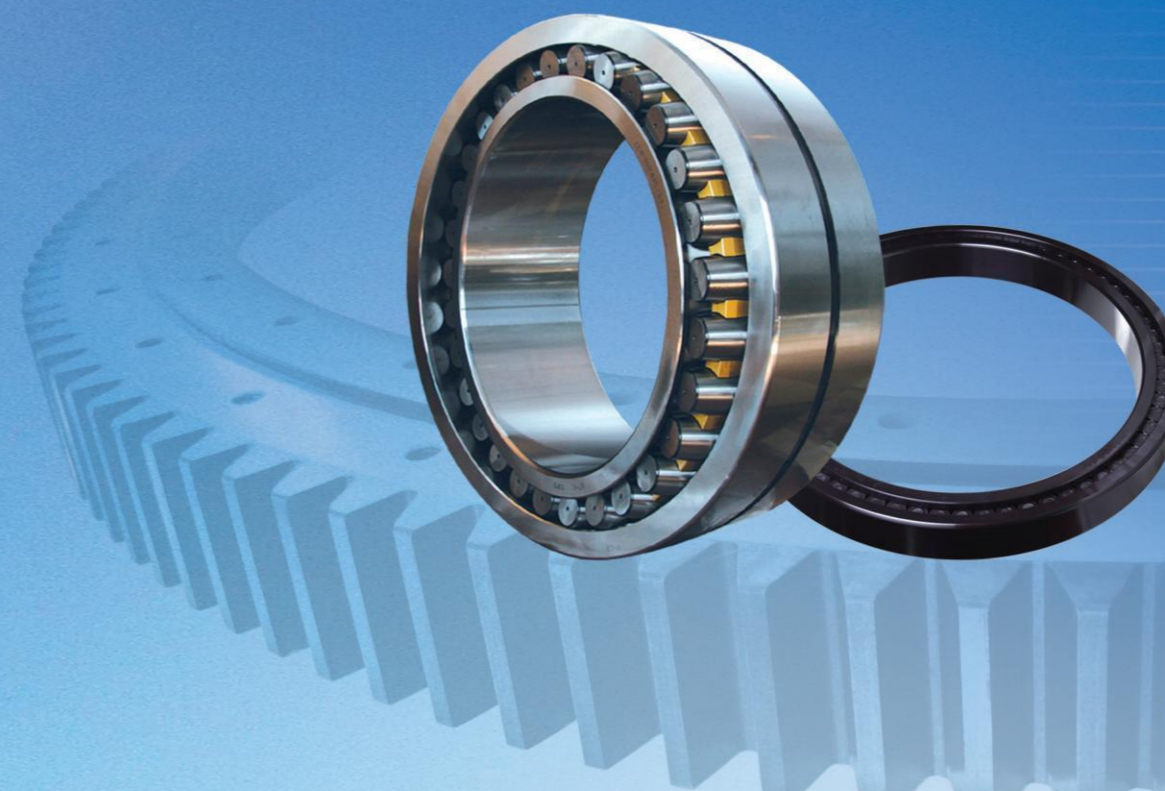

 瓦房店轴承集团有限责任公司
WAFANGDIAN BEARING GROUP CORP.

瓦房店轴承集团有限责任公司
WAFANGDIAN BEARING GROUP CORP.

ZWZ/2016.8

ZWZ Group is one of largest wind power supporting bearing manufacturer at present, has been formed four major production bases including wind power slewing bearing, wind power main bearing, wind power accelerator and driving devices and wind power motor. Comperhensively manufacturing pitch bearing, yaw bearing, main bearing, accelerator, driving devices, electric generator 6 main series products, realize locoliaztion of MW level wind power bearing. The market share takes the front rank in domestic market, meanwhile exporting products to international famous enterprises.

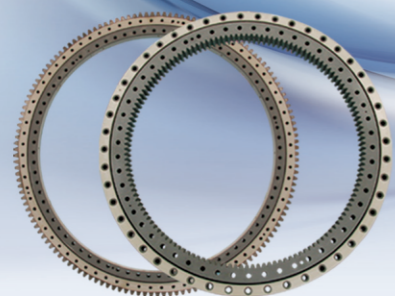

Pitch & Yaw Bearing



Main Bearing

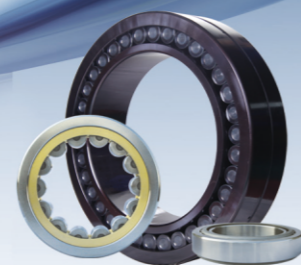

Accelerator Bearing



Driving Device Bearing



Electric Generator Bearing

1 风电轴承代号编制方法

1 Preparation method of Wind power bearing code compilation method

1.1 偏航、变桨轴承代号

ZWZ偏航、变桨轴承代号由前置代号、基本代号及后置代号三部分构成。

1.1 Code of Yaw bearing and Pitch bearing

The code of yaw bearing and pitch bearing consists of preposition code, basic code and postposition code.

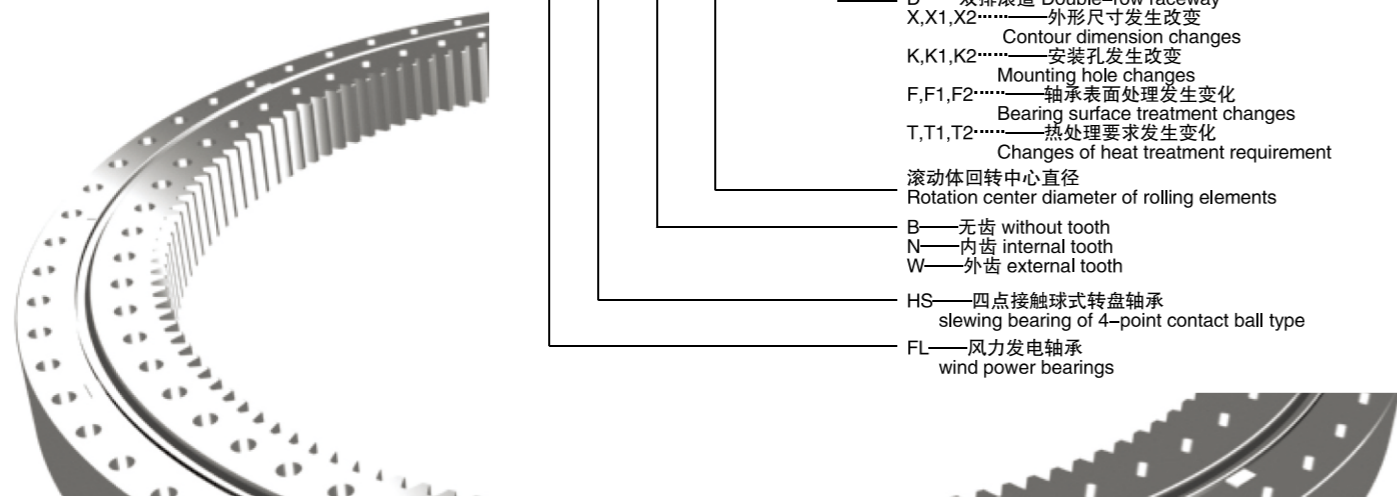

1.2 传动系统轴承代号

传动系统轴承包括主轴轴承、增速箱轴承、驱动装置轴承及发电机轴承。ZWZ传动系统轴承代号由前置代号、基本代号及后置代号三部分构成。

1.2 Code of transmission system bearing

Transmission system bearings include main shaft bearings, gearbox bearings, driving device bearings and generator bearings. The ZWZ transmission system bearing code consists of preposition code, basic code and postposition.

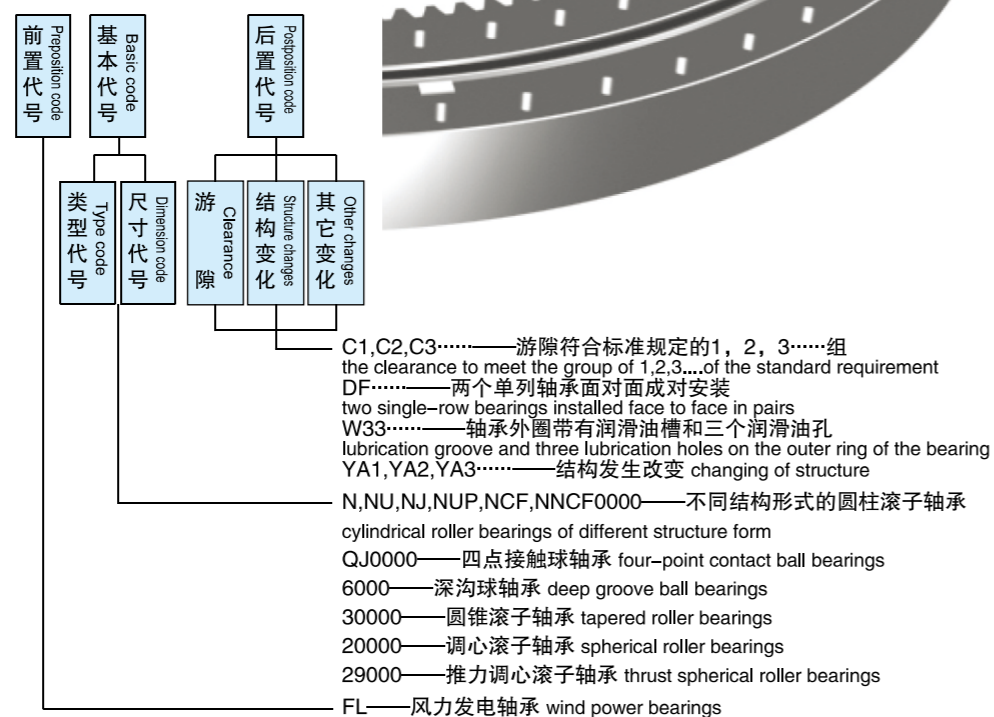

2

2 Windpower Bearing Structure and Critical Technology

Pitch & Yaw Bearing

Structure Type

Yaw and pitch bearing structure is single or double-row four-point contact slewing ball bearing.

Critical Technology

- 1) Advanced Heat-treatment Technology.
- 2) Realize the requirements of high raceway hardness and hardening layer depth.
- 3) Soft zone automatic grinding technology: soft zone automatic grinding equipment developed independently, which can realize high grinding quality to soft zone.
- 4) Sealing ring adhesion technology: adopts special tools , realize high adhesion quality.

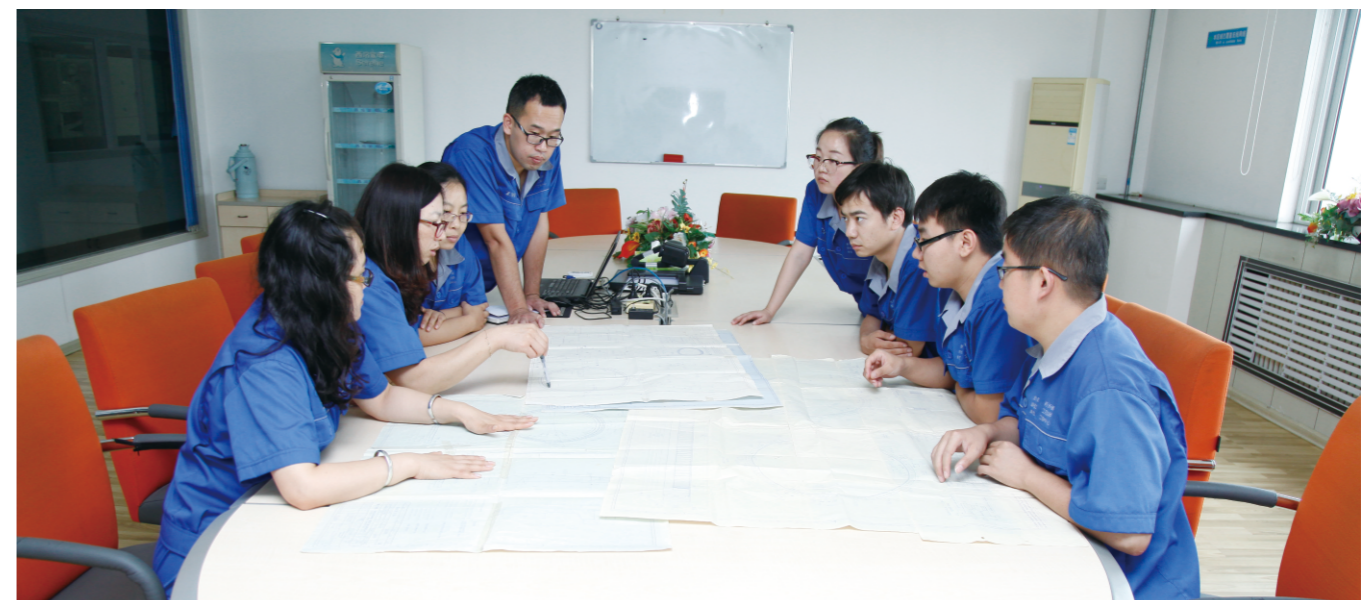
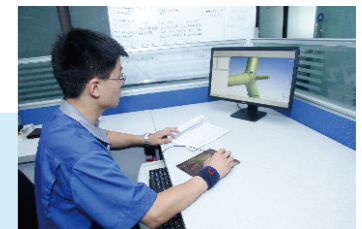

Main Bearing

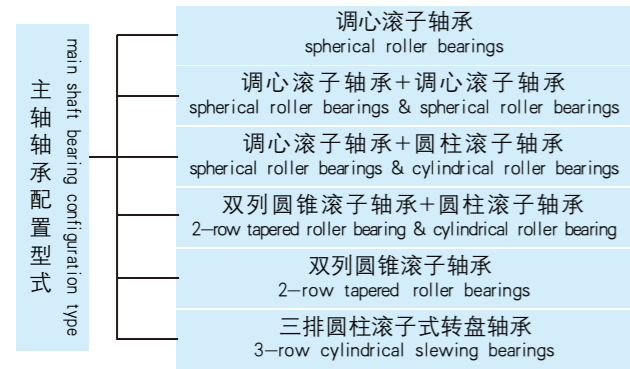

Structure Type

Because of there are different design of wind turbine transmission system, there are many types of main bearing structure.

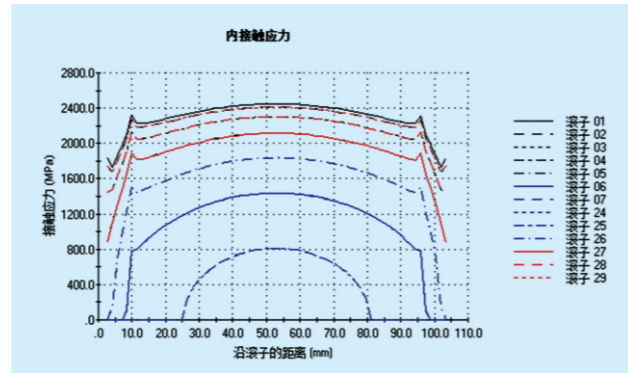

Accelerator Bearing

Structure Type

According to application position, the accelerator bearing can be divided into low speed-end bearing, intermediate shaft bearing and high speed-end bearing. Product structure type can be divided into cylindrical roller bearing, tapered roller bearing, spherical roller bearing, thrust self-aligning roller bearing, four-point contact ball bearing.

Critical Technology

1) Bearing Structure Design

Rolling element and flange surface adopts special structure design, which can improve bearing axial load carrying capacity; Latest cage structure design, realize well guiding to rolling elements, which guarantees bearing has a good running performance under high speed condition.

2) Bearing Surface Black Oxide Treatment,

Technology, Adopts advanced European black oxide treatment technology

3) Introduced bearing ring and rolling element UTT defect detect technology

4) Inspection Technology, Introduced advanced instrument, adopt international standard, realized bearing layout inspection.

Structure Characteristic of Driving Device Bearing

Driving devices including pitch driver and yaw driver. Bearing type can be divided into tapered roller bearing, spherical roller bearing, cylindrical roller bearing and deep groove ball bearing.

3 Windpower bearing model selection Calculation

ZWZ
FEA

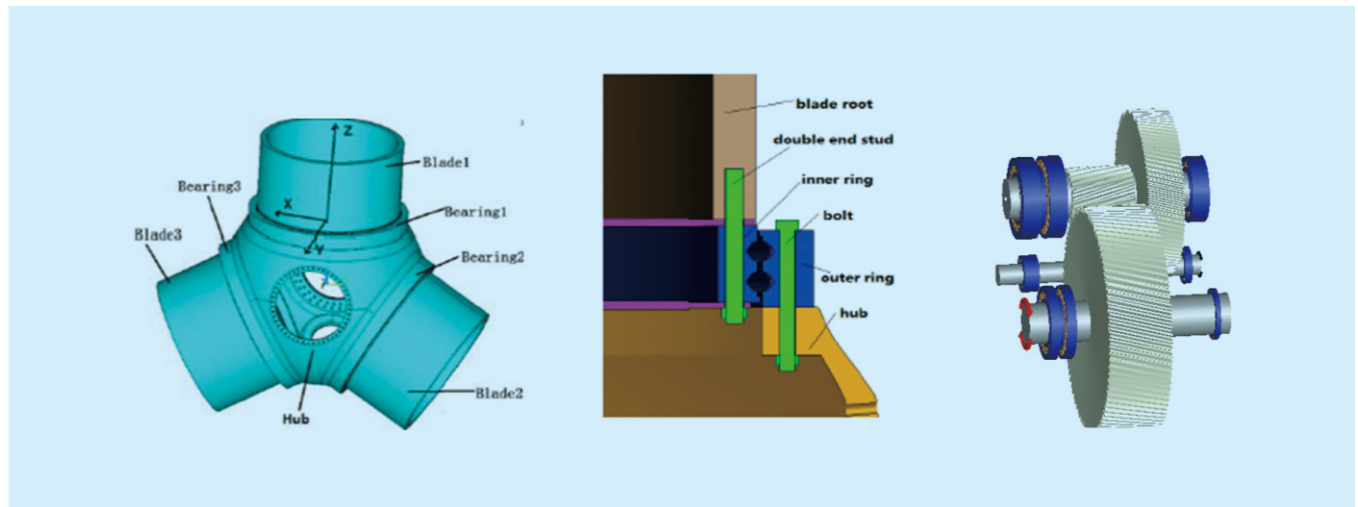

ZWZ可与客户的主机设计进行轴承选型的同步设计。

客户在选用ZWZ轴承前，需向ZWZ提供轴承使用工况载荷（静态载荷、疲劳载荷谱）、载荷坐标系以及传动系统布置结构等，ZWZ根据轴承应用工况进行轴承选型计算。

Structure Characteristic of Electric Generator Bearing

ZWZ发电机轴承为绝缘轴承，包括滚动体为陶瓷球的深沟球轴承及套圈表面进行绝缘处理的圆柱滚子轴承。

ZWZ electric generator bearing is insulated bearing, including deep groove ball bearing which rolling element is ceramic ball and cylindrical roller bearing which ring surface conduct by insulated treatment.

Because of windpower bearing needs to guarantee the requirements of high reliability and long life, ZWZ conduct model selection calculation to all wind turbine model, including bearing FEA calculation, life calculation, bolt strength calculation and tooth strength calculation and etc.

- 1
- 2
- 3 UTT
- 4
- 5

4

4 Wind power bearing installation and maintaining

ZWZ

ZWZ ZWZ

Because the customized design of ZWZ windpower bearing, when customer choose ZWZ bearing, ZWZ will provide detailed bearing mounting and maintaining instructions to customers.



风电系列轴承型号目录

WIND POWER BEARING CATALOGUE



偏航轴承 YAW BEARING

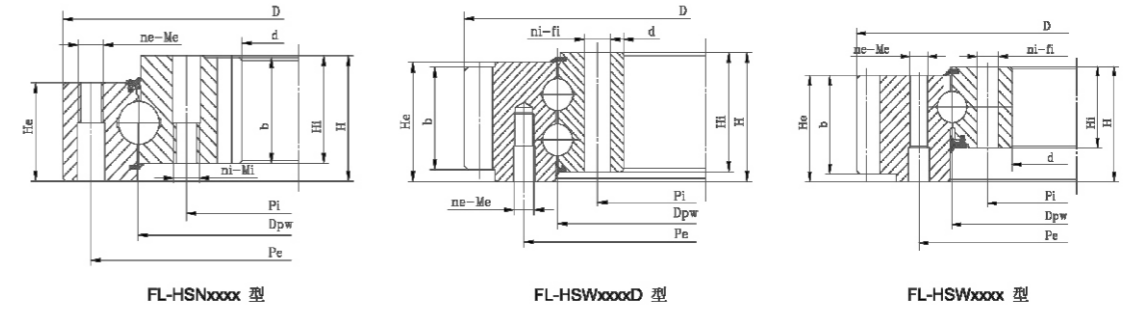

轴承代号 Bearing Designation	外形尺寸 Boundary Dimension						安装尺寸 Mounting Dimension			安装尺寸 Mounting Dimension					齿轮参数 Gear Parameter				重量 Weight kg	机型 WT
	d	D	H	Hi	He	Dpw	Pi	Pe	ni	fi	Mi	ne	fe	Me	b	m	z	x		
	mm						mm			mm					mm					
FL-HSW800FT1	710	924	67	58	58	800	744	854	30	13		30		12	58	6	152	0	108	60kW
FL-HSN1872FT1	1628	2051	140	120	110	1872	1759	1985	48	33	30	48	33	30	120	14	118	0	931	1.0MW
FL-HSN2182FT	1988	2299	109	100	72	2182	2108	2255	60	22	20	44	22	20	99.5	14	143	0.5	595	1.0MW
FL-HSW2330DFT1	2137	2616	183	169	169	2330	2215	2436	68	39		64	33	30.3	145	20	128	0.5	1830	1.5MW
FL-HSW2330DX1FT1	2135	2616	185	170	170	2330	2215	2436	68	39		64	33	30	145	20	128	0.5	1830	1.5MW
FL-HSW2330DX2FT1	2135	2616	185	170	170	2330	2215	2436	68	39		64	33	30	145	20	128	0.5	1830	1.5MW
FL-HSW2330DX3FT1	2135	2616	185	170	171	2330	2215	2436	68	39		64	33	30	147	20	128	0.5	1900	1.5MW
FL-HSW2330DX5FT1	2135	2616	185	170	170	2330	2215	2436	68	39		64	33	30	147	20	128	0.5	1890	1.5MW
FL-HSW2330DX6FT1	2135	2636	204	169	190	2330	2215	2436	68	39		64	33	30	145	20	129	0.5	2110	1.5MW
FL-HSW2330DK1	2135	2636	204	169	190	2330	2215	2436	68	39		64	33	30	145	20	129	0.5	2085	1.5MW
FL-HSW2355FT1	2184	2624.4	130	109	121	2355	2250	2460	75	33		76	33	30	120	18	143	0.5	1211	1.5MW
FL-HSW2355X1FT1	2184	2624.4	159	109	150	2355	2250	2460	75	33		76	33	30	120	18	143	0.5	1360	1.5MW
FL-HSW2442DFT1	2225	2790	204	169	190	2442	2320	2564	72	39		64	39	36	189	22	124	0.5	2600	1.5MW
FL-HSN2545	2360	2896	149	106	140	2545	2434	2658	72	39		72	39		139	20	142	0.5	1780	1.5MW
FL-HSW2600FT1	2422	2858	151	116	135	2600	2496	2706	84	33		84	39	36	135	16	177	0.5	1470	1.5MW
FL-HSN2718FT1	2469.6	2908	137	124	95	2718	2615	2830	90	30	27	90	30		120	18	138	0.5	1240	1.5MW
FL-HSN2718FT1S	2469.6	2908	137	124	95	2718	2615	2830	90	30	27	90	30		120	18	138	0.5	1240	1.5MW
FL-HSN2718F1T1	2469.6	2908	137	124	95	2718	2615	2830	90	30	27	90	30		120	18	138	0.5	1240	1.5MW
FL-HSW2718FT1	2560	3020.4	137	97	125	2718	2630	2806	100	26		100	26	24	120	18	165	0.5	1550	1.5MW
FL-HSW2765F1T2	2617	3002.4	137	92	125	2765	2677	2850	84	30		84	30	27	120	18	164	0.5	1187	1.5MW
FL-HSW2765FT1	2617	3002.4	137	92	125	2765	2677	2850	84	30		84	30	27	120	18	164	0.5	1190	1.5MW
FL-HSN2297FT1	2034	2500	170	160	120	2297	2194	2441	72	33	30	72	33	30	149	18	114	0.5	1500	2.0MW
FL-HSW2462DFT1	2274	2756	170	160	150	2462	2354	2568	60	39		60	39	36	125	20	135	0.5	1660	2.0MW
FL-HSN2690FT1	2380	2900	162	150	140	2690	2560	2820	90	36	33	84	36	33	140	20	120	0.5	2000	2.0MW
FL-HSN2690KFT1	2380	2900	162	150	140	2690	2560	2820	90	36	33	84	36	33	140	20	120	0.5	2000	2.0MW
FL-HSN2690X1FT1	2380	2900	189	175	140	2690	2560	2820	90	36	33	84	36	33	165	20	120	0.5	2190	2.0MW
FL-HSN2690X1KFT1	2380	2900	189	175	140	2690	2560	2820	90	39	36	84	39	36	165	20	120	0.5	2190	2.0MW
FL-HSW2755FT1	2600	3002.4	137	100	125	2755	2660	2850	84	30	27	84	30		120	18	164	0.5	1300	2.0MW
FL-HSW2765X1S	2617	3002.1	147	102	139	2765	2677	2850	84	30		84	30	27	130	18	164	0.5	1292	2.0MW
FL-HSW2775FT1	2520	3136	160	125	145	2775	2665	2885	96	39		96	39	36	135	20	154	0.5	2396	2.0MW
FL-HSW2804FT1	2617	3096	159	124	149	2804	2698	2908	64	39		64	39	36	135	20	152	0.5	1870	2.0MW
FL-HSW2805K	2600	3092.4	190	125	180	2805	2680	2920	95	39		100	33	30	175	18	169	0.5	2150	2.0MW

d D H Dpw P n
f M b m z x
e i

Notes d Interdiameter of bearing D Outer H Width of bearing Dpw Center diameter of roller
P Center diameter of mounting holes n No. of mounting holes f Diameter of mounting holes
M Diameter of screwholes b Sear width m Module z No. of gears x Addendum.
Euffix e Outer ring i Innterring

偏航轴承 YAW BEARING

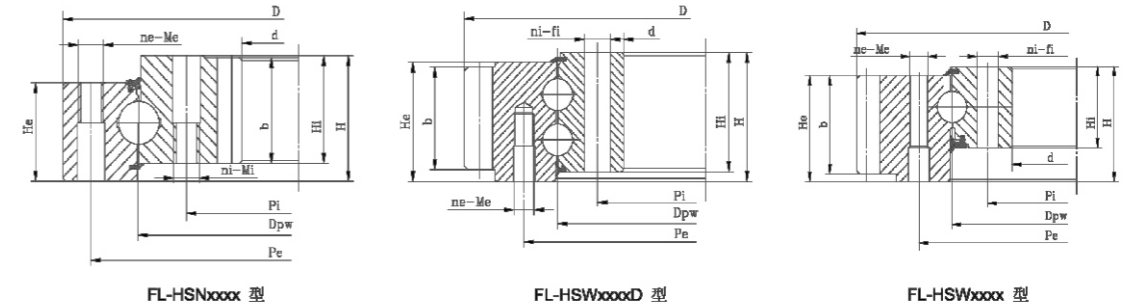

轴承代号 Bearing Designation	外形尺寸 Boundary Dimension						安装尺寸 Mounting Dimension			安装尺寸 Mounting Dimension					齿轮参数 Gear Parameter				重量 Weight kg	机型 WT
	d	D	H	Hi	He	Dpw	Pi	Pe	ni	fi	Mi	ne	fe	Me	b	m	z	x		
	mm						mm			mm					mm					
FL-HSW2805	2621	3092.4	190	125	180	2805	2690	2920	95	33		100	33	30	175	18	169	0.5	2105	2.0MW
FL-HSW2849FT1	2657	3136	140	116	125	2849	2743	2955	96	39		96	39	36	125	20	154	0.5	1600	2.0MW
FL-HSW2854D	2657	3136	195	160	180	2854	2743	2965	96	39		96	39		180	20	154	0.5	2255	2.0MW
FL-HSN2980FT1	2664	3180	144	134	123	2980	2860	3100	72	39	36	72	39		125	20	134	0.5	1960	2.0MW
FL-HSN2980F1T1	2664	3180	144	134	123	2980	2860	3100	72	39	36	72	39		125	20	134	0.5	1960	2.0MW
FL-HSN2980K	2664	3180	144	134	123	2980	2860	3100	72	39	36	84	39		125	20	134	0.5	1950	2.0MW
FL-HSN2980X1FT1	2664	3180	144	134	123	2980	2860	3100	72	39	36	72	39		125	20	134	0.5	1960	2.0MW
FL-HSN2980X2FT1	2664	3180	193	179	127	2980	2860	3100	72	39	36	72	39		170	20	134	0.5	2410	2.0MW
FL-HSN2980X3FT1	2664	3180	144	132	125	2980	2860	3100	72	39	36	72	39		120	20	134	0.5	1960	2.0MW
FL-HSN2980X4FT1	2664	3180	199	189	125	2980	2860	3100	72	39	36	72	39		180	20	134	0.5	2480	2.0MW
FL-HSN2980X4K	2664	3180	199	189	125	2980	2860	3100	72	39	36	72	39		180	20	134	0.5	2460	2.0MW
FL-HSN2980X5	2664	3180	180	170	123	2980	2860	3100	72	39	36	84	39		160	20	134	0.5	2270	2.0MW
FL-HSW2992	2811	3272.4	138	125	128	2992	2877	3107	95	33		96	33	30	179	18	120	0.5	1800	2.0MW
FL-HSW3050	2830	3356	145	122	136	3050	2925	3175	83	39		84	33	30	135	20	165	0.5	2140	2.0MW
FL-HSW3050X1	3355	2830	200	134	190	3050	2925	3175	120	36	33	100	39		190	24	137	0.5	2570	2.0MW
FL-HSW3050X1K	3355	2830	200	134	190	3050	2925	3175	100	39		100	39	36	190	24	137	0.5	2600	2.0MW
FL-HSN3460D	3124	3680	212	198	184	3460	3340	3580	72	39	36	72	39		190	22	143	0.5	3760	2.0MW
FL-HSW2775DX1FT1	2560	3141.6	231	199	218	2775	2660	2890	96	39		96	45	36	208	22	140	0.5	3470	2.5MW
FL-HSW2804D	2617	3141.6	210	180	200	2804	2698	2908	80	39		80	39	36	195	20	128	0.5	2807	2.1MW
FL-HSN2980X6	2628	3180	238	224	127	2980	2860	3100	72	39	36	72	39		215	25	106	0.5	3015	2.1MW
FL-HSW2992D	2811	3276	183	168	173	2992	2877	3107	119	33		112	33	30	161	20	172	0.5	2350	2.5MW
FL-HSW3050	2830	3356	145	122	136	3050	2925	3175	83	39		84	33	30	135	20	165	0.5	2140	2.5MW
FL-HSW3050X2	2830	3358	180	134	170	3050	2925	3175	99	36		100	36	33	170	20	165	0.5	2400	2.5MW
FL-HSW2775DFT1	2560	3141.6	212	185	199	2775	2660	2890	96	39		96	39	36	189	22	140	0.5	3200	3.0MW
FL-HSN2837DFT1	2544	3037	198	179	187	2837	2720	2955	84	39	36	84	39		160	20	128	0.5	2440	3.0MW
FL-HSW2904D	2708	3196	182	169	169	2904	2782	3025	108	36		108	33	30	155	20	157	0.5	2320	3.0MW
FL-HSW2985D	2780	3276	190	168	180	2985	2870	3100	72	39		72	39	36	180	20	161	0.5	2605	3.0MW
FL-HSN3040FT1	2757.6	3250	135	126	132	3040	2920	3160	100	33	30	99	33		125.5	18	154	0.5	1940	3.0MW
FL-HSN3480DFT1	3168	3700	195	181	160	3480	3360	3600	72	39	36	72	39		180	22	145	0.5	3170	3.0MW
FL-HSN3035FT1	2757.6	3240	135	126	122	3035	2920	3150	116	33	30	118	33	30	125	18	154	0.5	1840	3.6MW
FL-HSW4340DFT1	4100	4703.6	219	205	205	4340	4200	4480	120	42		120	42	39	190	22	211	0.5	5400	5.0MW

f d D H b Dpw z x P n
e M i

Notes d Interdiameter of bearing D Outer H Width of bearing Dpw Center diameter of roller
P Center diameter of mounting holes n No. of mounting holes f Diameter of mounting holes
M Diameter of screwholes b Sear width m Module z No. of gears x Addendum.
Euffix e Outer ring i Innterring

偏航轴承 YAW BEARING

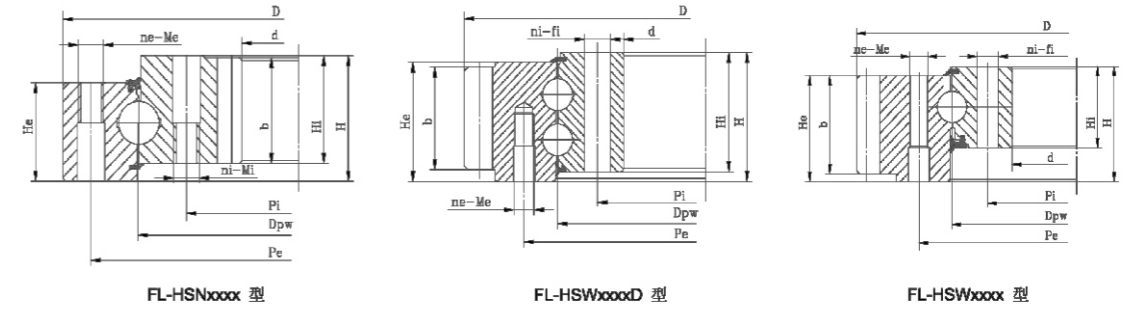

轴承代号 Bearing Designation	外形尺寸 Boundary Dimension						安装尺寸 Mounting Dimension			安装尺寸 Mounting Dimension					齿轮参数 Gear Parameter				重量 Weight kg	机型 WT
	d	D	H	Hi	He	Dpw	Pi	Pe	ni	fi	Mi	ne	fe	Me	b	m	z	x		
	mm						mm			mm					mm					
FL-HSW4652DFT1	4420	5011.2	204	191	190	4652	4514	4790	130	42		132	42	39	174	24	206	0.5	5170	5.0MW
FL-HSW4652DX1FT1	4410	5011.2	204	190	190	1652	4514	4790	130	42		132	42	39	185	24	206	0.5	5190	5.0MW
FL-HSW3960DFT1	3712	4387.2	220	207	210	3960	3832	4089	108	39		108	39	36	200	24	180	0.5	5810	6.0MW

f d D H b Dpw z x P n
e i

Notes d Intherdiameter of bearing D Outer H Width of bearing Dpw Center diameter of roller
P Center diameter of mounting holes n No.of mounting holes f Diameter of mounting holes
M Diameter of screwholes b Sear width m Module z No. of gears x Addendum.
Euffix e Outer ring i Innterring

变桨轴承 BLADE BEARING

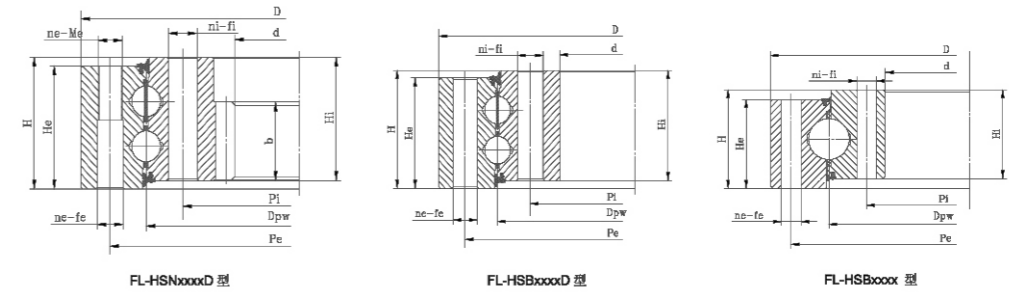

轴承代号 Bearing Designation	外形尺寸 Boundary Dimension						安装尺寸 Mounting Dimension			安装尺寸 Mounting Dimension					齿轮参数 Gear Parameter				重量 Weight kg	机型 WT
	d	D	H	Hi	He	Dpw	Pi	Pe	ni	fi	Mi	ne	fe	Me	b	m	z	x		
	mm						mm			mm					mm					
FL-HSN420FT1	325	495	58	48	48	420	375	469	24		12	24	14		48	5	67	0	37	60kW
FL-HSB1100FT	945	1255	130	117	117	1100	1000	1200	52		26	47	26						407	850KW
FL-HSN1715FT1	1454	1905	140	126	113	1715	1600	1830	50		33	50	33		90	12	122	0.5	918	1.0MW
FL-HSN1700DFT1	1470	1870	142	132	134	1700	1600	1800	50		33	50	33		100	10	148	0.5	878	1.25MW
FL-HSB1697DF	1524	1895	182	169	169	1697	1590	1800	54		33	54	33						1110	1.5MW
FL-HSB1697DX1F	1524	1895	182	169	169	1697	1590	1800	54		33	64	33						1100	1.5MW
FL-HSB1697DKF	1524	1895	182	169	169	1697	1590	1800	60		33	64	33						1113	1.5MW
FL-HSN1900DFT	1657.3	2080	144	135	133	1900	1800	2000	54		33	48	33		135	12	139	0.5	1180	1.5MW
FL-HSN1900DXFT1	1657.3	2080	169	159	159	1900	1800	2000	54		33	54	33		100	12	139	0.5	1240	1.5MW
FL-HSN1900DX1FT1	1657.3	2080	168	158	158	1901	1800	2000	54		32	54	33		100	12	139	0.5	1250	1.5MW
FL-HSN1900DX2FT1	1657.3	2080	168	158	158	1901	1800	2000	54		32	54	33		100	12	139	0.5	1230	1.5MW
FL-HSN1900DX2KFT1	1657.3	2080	168	158	158	1901	1800	2000	54		33	54	33		100	12	139	0.5	1230	1.5MW
FL-HSN1900DX3FT1	1657.3	2080	168	158	158	1901	1800	2000	54		33	54	33		100	12	139	0.5	1235	1.5MW
FL-HSN1900DX4FT1	1657	2080	182	169	169	1900	1800	2000	54		33	54	33		100	12	139	0.5	1293	1.5MW
FL-HSN1900DX4KFT1	1657	2080	182	169	169	1900	1800	2000	54		33	54	33		100	12	139	0.5	1293	1.5MW
FL-HSN1900DX4-A5	1657.3	2080	182	169	169	1901	1800	2000	54		33	54	33		100	12	139	0.5	1297	1.5MW
FL-HSN1900DX5FT1	1657.3	2080	168	158	158	1901	1800	2000	54		33	54	33		100	12	139	0.5	1235	1.5MW
FL-HSN1900DX6FT1	1657.3	2080	168	158	158	1901	1800	2000	54		33	54	33		100	12	139	0.5	1230	1.5MW
FL-HSN1900DX6FT2	1657.3	2080	168	158	158	1901	1800	2000	54		33	54	33		100	12	139	0.5	1230	1.5MW
FL-HSN1900DX6KFT2	1657.3	2080	168	158	158	1901	1800	2000	54		33	54	33		100	12	139	0.5	1230	1.5MW
FL-HSN1900DX8FT1	1657.3	2080	168	158	158	1901	1800	2000	54		33	54	33		100	12	139	0.5	1250	1.5MW
FL-HSN1900DA5	1657.3	2080	168	158	158	1901	1800	2000	54		33	54	33		100	12	139	0.5	1225	1.5MW
FL-HSN1901DFT1	1657.2	2080	170	159	159	1901	1800	2000	54		39	68	36		100	12	139	0.5	1170	1.5MW
FL-HSN1901DX1	1657.3	2080	168	158	158	1901	1800	2000	64		33	64	33		100	12	139	0.5	1215	1.5MW
FL-HSN2221DX5KFT1	1946.4	2410	178	168	168	2221	2110	2332	64		36	80	33		120	12	163	0.5	1650	1.5MW
FL-HSN1890DFT1	1652	2053	150	138	138	1890	1800	1984	54		33	60	33		120	14	119	0.5	1030	2.0MW
FL-HSN1892DFT1	1652	2053	160	148	150	1892	1800	1984	54		33	60	33		120	14	119	0.5	1040	2.0MW
FL-HSN1900DX7FT1	1652	2060	188	179	175	1900	1800	2000	64		30	72	30		120	14	119	0.5	1252	2.0MW
FL-HSN1900DX2FT1-A5	1657.3	2080	168	158	158	1901	1800	2000	54		32	54	33		100	12	139	0.5	1230	2.0MW

f d D H b Dpw z x P n
e i

Notes d Inner diameter of bearing D Outer H Width of bearing Dpw Center diameter of roller
P Center diameter of mounting holes n No. of mounting holes f Diameter of mounting holes
M Diameter of screwholes b Sear width m Module z No. of gears x Addendum.
Euffix e Outer ring i Inner ring

变桨轴承 BLADE BEARING

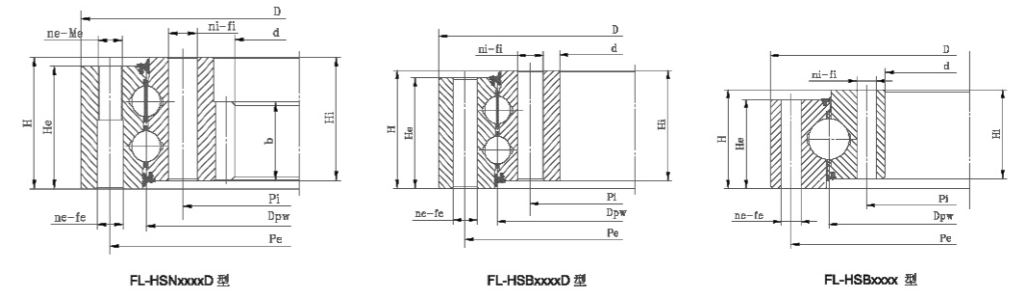

轴承代号 Bearing Designation	外形尺寸 Boundary Dimension						安装尺寸 Mounting Dimension			安装尺寸 Mounting Dimension					齿轮参数 Gear Parameter				重量 Weight kg	机型 WT
	d	D	H	Hi	He	Dpw	Pi	Pe	ni	fi	Mi	ne	fe	Me	b	m	z	x		
	mm						mm			mm					mm					
FL-HSW2175DX1	1910	2457.6	228	215	215	2175	2022	2022	71	45		64	39		120	12	202	0.5	2410	2.0MW
FL-HSW2175DX1	1910	2457.6	228	215	215	2175	2022	2022	71	45		64	39		120	12	202	0.5	2410	2.0MW
FL-HSW2175DX1K	1910	2457.6	228	215	215	2175	2022	2022	71	45		92	39		120	12	202	0.5	2370	2.0MW
FL-HSW2175D	1970	2457.6	228	215	215	2175	2052	2052	71	39		92	39		120	12	202	0.5	2085	2.0MW
FL-HSB2175D	1970	2446	228	215	215	2175	2052	2052	71	39		64	39							2.0MW
FL-HSN2217DFT1	1896	2404	199	189	159	2217	2110	2110	60	39		80	39		120	12	159	0.5	1900	2.0MW
FL-HSN2221DX4FT1	1920	2418	191	181	181	2221	2110	2110	64	33		64	33		120	12	161	0.5	1940	2.0MW
FL-HSN2221DFT1	1944	2410	179	169	169	2215	2110	2110	60	39		60	39		120	12	163	0.5	1680	2.0MW
FL-HSN2221DX1FT1	1944	2410	199	189	189	2221	2110	2110	60	39		60	39		120	12	163	0.5	1850	2.0MW
FL-HSN2221DX1KFT1	1944	2410	199	189	189	2221	2110	2110	60	39		60	39		120	12	163	0.5	1850	2.0MW
FL-HSN2221DX1K1	1944	2410	199	189	189	2221	2110	2110	60	39		72	39		120	12	163	0.5	1840	2.0MW
FL-HSN2221DX1K2FT1	1944	2410	199	189	189	2221	2110	2110	60	39		60	39		120	12	163	0.5	1850	2.0MW
FL-HSN2221DX1K3	1944	2410	199	189	189	2221	2110	2110	60	39		79	39		120	12	163	0.5	1820	2.0MW
FL-HSN2221DX3FT1	1944	2410	199	189	189	2221	2110	2110	60	39		60	39		120	12	163	0.5	1850	2.0MW
FL-HSN2221DX3KFT1	1944	2410	199	189	189	2221	2110	2110	60	39		60	39		120	12	163	0.5	1850	2.0MW
FL-HSN2221DX5FT1	1946.4	2410	178	168	168	2221	2110	2110	64	33		80	33		120	12	163	0.5	1610	2.0MW
FL-HSN2221DX6	1944	2420	199	189	189	2221	2097	2097	56	42		79	39		120	12	163	0.5	1875	2.0MW
FL-HSN2221DX2FT1	1956	2410	200	191	189	2221	2110	2110	60	39		60	39		100	12	164	0.5	1800	2.0MW
FL-HSN2225DFT1	1960	2420	196	184	184	2225	2110	2110	60	39		60	39	36	125	14	141	0.5	1790	2.0MW
FL-HSN2225DKF1T1	1960	2420	196	184	184	2225	2110	2110	64	33		60	39	36	125	14	141	0.5	1810	2.0MW
FL-HSN2225DX1FT1	1960	2420	192	182	182	2225	2110	2110	60	39		60	39		125	14	141	0.5	1740	2.0MW
FL-HSN2225DX1KFT1	1960	2420	192	182	182	2225	2110	2110	60	39		60	39	36	125	14	141	0.5	1785	2.0MW
FL-HSN2230D	1936	2446	229	219	219	2230	2110	2110	64	39		72	39		130	16	122	0.5	2330	2.0MW
FL-HSN2410DX1K	2144	2620	197	184	184	2410	2300	2300	64	39		92	39		128	16	135	0.5	1940	2.0MW
FL-HSN2410DX4	2146	2620	197	184	184	2410	2300	2300	92	39		92	39		128	16	135	0.5	1890	2.0MW
FL-HSN2410DX5	2147	2620	195	182	182	2410	2300	2300	84	39		92	39		135	16	135	0.5	1897	2.0MW
FL-HSN2410DX5K	2147	2620	195	182	182	2410	2300	2300	84	39		64	39		135	16	135	0.5	1949	2.0MW
FL-HSN2423D	2144	2646	223	210	210	2423	2300	2300	92	39		84	39		135	16	135	0.5	2315	2.0MW
FL-HSN2423DX1MK	2142	2630	215	202	202	2423	2300	2300	64	39		91	39		128	14	154	0.5	2200	2.0MW
FL-HSN2250D	1896	2474	199	189	189	2250	2110	2110	60	39		79	39		120	12	159	0.5	2330	2.1MW
FL-HSN2203DFT1	1956	2392	181	171	171	2203	2100	2100	60	39		60	39		100	12	164	0.5	1450	2.1MW
FL-HSN2410DX6	2147	2620.00	195	182	182	2410	2300	2300	92	39		84	39		135	16	135		1900	2.3MW
FL-HSN2418D	2160	2615	191	181	181	2418	2300	2300	64	39		64	39		120	12	181		1900	2.3MW

d D H Dpw P n
f M b m z x
e i

Notes d Interdiameter of bearing D Outer H Width of bearing Dpw Center diameter of roller
P Center diameter of mounting holes n No. of mounting holes f Diameter of mounting holes
M Diameter of screwholes b Sear width m Module z No. of gears x Addendum.
Euffix e Outer ring i Innterring

变桨轴承 BLADE BEARING

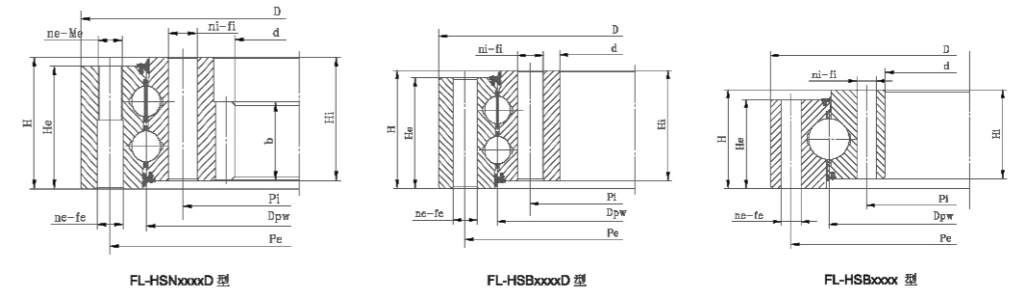

轴承代号 Bearing Designation	外形尺寸 Boundary Dimension						安装尺寸 Mounting Dimension			安装尺寸 Mounting Dimension					齿轮参数 Gear Parameter				重量 Weight kg	机型 WT
	d	D	H	Hi	He	Dpw	Pi	Pe	ni	fi	Mi	ne	fe	Me	b	m	z	x		
	mm						mm			mm					mm					
FL-HSB2421DFT	2226	2647	237	224	224	2421	2300	2552	54	39		54	39						2400	2.3MW
FL-HSB2421D	2226	2677	237	224	224	2421	2300	2552	54	39		54	39						2630	2.3MW
FL-HSB2421DK	2226	2677	237	224	224	2421	2300	2552	54	39		100	39						2540	2.3MW
FL-HSB2421DK1	2226	2677	237	224	224	2421	2300	2558	54	39		106	39						2520	2.3MW
FL-HSB2421DKFT	2226	2677	237	224	224	2421	2300	2552	54	39		100	39						2540	2.3MW
FL-HSB2154D	1908	2446	264	251	251	2154	2300	2350	78	39		92	39							2.5MW
FL-HSW2180DFT1	1940	2526.70	207	194	194	2180	2060	2300	72	39		64	39		135	16	155	0.5	2500	2.5MW
FL-HSN2410DX4	2146	2620	197	184	184	2410	2300	2520	92	39		92	39		128	16	135	0.5	1890	2.5MW
FL-HSN2420D	2147	2630	233	220	220	2420	2300	2540	92	39		82	39		135	16	135	0.5	2320	2.5MW
FL-HSN2410DX1FT2	2144	2615	197	184	184	2410	2300	2520	64	39		92	39		135	16	135	0.5	1955	3.0MW
FL-HSN2410DFT1	2147	2620	195	182	182	2410	2300	2520	64	39		82	39		135	16	135	0.5	1930	3.0MW
FL-HSN2410DX2FT1	2144	2620	197	184	184	2410	2300	2520	64	39		92	39		135	16	135	0.5	1940	3.0MW
FL-HSN2423DX1	2144	2630	215	202	202	2423	2300	2546	92	39		92	39		135	16	135	0.5	2120	3.0MW
FL-HSB2485DFT	2290	2678	228	203	202	2485	2371	2600	72	39		72	39							3.0MW
FL-HSB2640DFT	2420	2920	282	259	280	2640	2500	2780	72	39	100	39							3780	3.6MW
FL-HSB2648D	2420	2966	271	254	254	2648	2500	2802	72	39		108	45						3830	4.0MW
FL-HSN3350DFT1	2964	3620	264	251	251	3350	3127	3500	128	39		126	39		160	20	149	0.5	5160	5.0MW
FL-HSN3350DX1FT1	2964	3620	264	251	251	3350	3127	3500	128	39		126	39		160	20	149	0.5	5180	5.0MW
FL-HSN3340DFT1	2988	3675	272	259	259	3340	3139	3480	96	45		112	45		120	18	167	0.5	5700	6.0MW

d D H Dpw P n
f M
e i b m z x

Notes d Interdiameter of bearing D Outer H Width of bearing Dpw Center diameter of roller
P Center diameter of mounting holes n No. of mounting holes f Diameter of mounting holes
M Diameter of screwholes b Sear width m Module z No. of gears x Addendum.
Euffix e Outer ring i Innterring

增速机轴承 GEARBOX BEARING

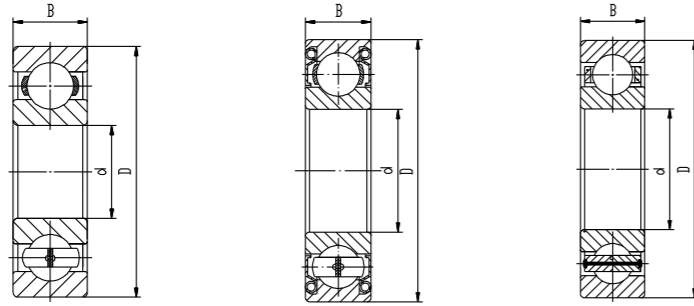

轴承代号 Bearing Designation	外形尺寸 Boundary Dimension			基本额定载荷 Basic load rating		重量 Weight	机型 WT
	d	D	B	Cr	Cor		
	mm			kN		kg	
FL-6005/C3	25	47	12	10	5.85	0.0787	1.5MW
FL-6010	50	80	16	20.8	15.4	0.255	1.5MW
FL-6210	50	90	20	33	21.8	0.474	1.5MW
FL-6216-2Z	80	140	26	66	50	1.5	1.5MW
FL-6026	130	200	33	100	94	3.29	1.5MW
FL-61984MA/C3	420	560	65	320	520	46.2	1.5MW

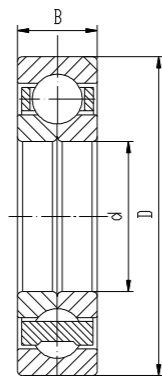

轴承代号 Bearing Designation	外形尺寸 Boundary Dimension			基本额定载荷 Basic load rating		重量 Weight	机型 WT
	d	D	B	Cr	Cor		
	mm			kN		kg	
FL-QJ222N2	110	200	38	250	285	5.37	800KW
FL-QJ324N2	120	260	55	310	515	15.2	1.5MW
FL-QJ226N2	130	230	40	290	370	7.5	1.5MW
FL-QJ326N2	130	280	58	420	560	20.1	1.5MW
FL-QJ228N2	140	250	42	315	410	9.63	1.5MW
FL-QJ332N2/C3	160	340	68	540	785	31.1	2.0MW
FL-QJ232N2/C3	160	290	48	370	530	14.9	2.0MW
FL-QJ328N2/C3	140	300	62	469	645	22.5	2.5MW
FL-QJ228N2/C3	140	250	42	315	410	9.63	8MW

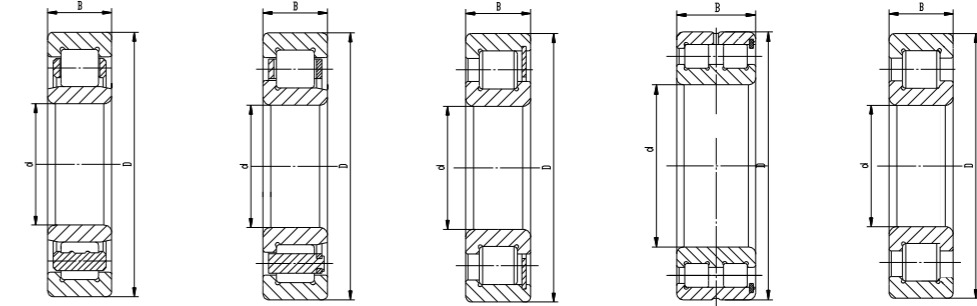

轴承代号 Bearing Designation	外形尺寸 Boundary Dimension			基本额定载荷 Basic load rating		重量 Weight	机型 WT
	d	D	B	Cr	Cor		
	mm			kN		kg	
FL-NU1016M	80	125	22	60	80	1.1	800KW
FL-NU2222EM	110	200	53	370	500	7.63	800KW
FL-NJ2232EM	160	290	80	810	1190	24.7	800KW
FL-NCF1868V	340	420	38	440	940	11.5	800KW
FL-NCF1892V	460	580	56	1050	2100	34.4	800KW
FL-NJ2324EQ1A	120	260	86	860	1040	24.1	1.5MW
FL-NJ2324EQ1A/C3	120	260	86	860	1040	24.1	1.5MW
FL-NU1026M	130	200	33	192	274	4.64	1.5MW
FL-NU226M	130	230	40	300	390	7.29	1.5MW
FL-NU2226EMA/C3	130	230	64	595	795	11.2	1.5MW
FL-NU2326MA	130	280	93	920	1230	28.7	1.5MW
FL-NU326EMA	130	280	58	595	795	18.7	1.5MW
FL-NU2228EMA/C3	140	250	68	574	836	14.2	1.5MW
FL-NU328MA/C3H	140	300	62	620	780	22.2	1.5MW
FL-NJ2330V	150	320	108	1380	1930	42.7	1.5MW
FL-NU2332EMA/C3H	160	340	114	1065	1590	49.7	1.5MW
FL-NNCF5034V/C3	170	260	122	1060	2120	21.4	1.5MW
FL-NU234EM	170	310	52	640	870	18.4	1.5MW
FL-NJ334M	170	360	72	857	1040	38.4	1.5MW
FL-NJ2334V	170	360	120	1700	2410	59.9	1.5MW
FL-NU2236EM	180	320	86	1040	1580	31.1	1.5MW
FL-NJ2236EMA	180	320	86	1010	1520	31.8	1.5MW
FL-NJ2240EM	200	360	98	1120	1900	44.1	1.5MW
FL-NNCF5044V/C3	220	340	160	1750	3650	53.1	1.5MW
FL-NJ244M	220	400	65	839	1220	35.4	1.5MW
FL-NCF2244V	220	400	108	1710	2530	53.1	1.5MW
FL-NJ2344V/C3H	220	460	145	2580	3530	111	1.5MW
FL-NCF2952V/C3	260	360	60	730	1390	17	1.5MW
FL-NU1964EMA	320	440	56	670	1150	24.7	1.5MW
FL-NU1072M	360	540	82	1450	2080	64.8	1.5MW
FL-NCF2888V	440	540	60	1020	2550	28.9	1.5MW
FL-NCF29/530V	530	710	106	2600	5600	110	1.5MW
FL-NCF18/530V	530	650	56	1020	2320	33.9	1.5MW
FL-NCF18/600V/HCEC9	600	730	60	1180	2950	50.5	1.5MW
FL-NCF18/670V	670	820	69	1320	3230	72.2	1.5MW
FL-NU224M	120	215	40	290	365	5.87	2.0MW
FL-NU2326EMA/C3M	130	280	93	930	1240	30	2.0MW

增速机轴承 GEARBOX BEARING

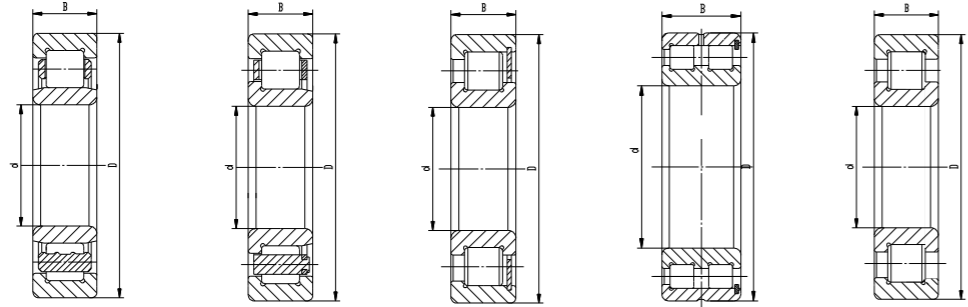

轴承代号 Bearing Designation	外形尺寸 Boundary Dimension			基本额定载荷 Basic load rating		重量 Weight kg	机型 WT
	d	D	B	Cr	Cor		
	mm			kN			
FL-NU1028M	140	210	33	183	263	3.89	2.0MW
FL-NU2330EMA	150	320	108	1140	1570	42.6	2.0MW
FL-NU332EMA	160	340	68	870	1080	31.4	2.0MW
FL-NU332EMA/C3M	160	340	68	870	1080	30.1	2.0MW
FL-NU2232EMA/C3	160	290	80	950	1210	23	2.0MW
FL-NJ2336V/DF	180	380	252	3210	5430	139	2.0MW
FL-NUP2336V	180	380	126	1870	2170	70.6	2.0MW
FL-NU2240EM/C3M	200	360	98	1240	1900	44.8	2.0MW
FL-NU2240EM/C3H	200	360	98	1240	1900	44.8	2.0MW
FL-NU2340EM/C3	200	420	138	2070	2940	95.5	2.0MW
FL-NNCF5052V/C3	260	400	190	2370	4950	85.9	2.0MW
FL-NNCF5052V/C3L	260	400	190	2660	5120	81.4	2.0MW
FL-NJ2980/HCEC9	400	540	82	1340	2780	56.2	2.0MW
FL-NU1080M/CNH	400	600	90	1420	2420	89.5	2.0MW
FL-NU1088M/CNH	440	650	94	1540	2680	106	2.0MW
FL-NJ2892/HCEC9	460	580	72	1090	2480	46.1	2.0MW
FL-NCF18/530V/CNL	530	650	56	1020	2320	33.9	2.0MW
FL-NU29/560/C3	560	750	112	2470	5570	146	2.0MW
FL-NCF18/560V/CNM	560	680	56	1010	2450	40.3	2.0MW
FL-NCF18/600V	600	730	60	1180	2950	50.5	2.0MW
FL-NCF18/600V/CNL	600	730	60	1180	2950	50.5	2.0MW
FL-NCF18/630V	630	780	69	1400	3270	70.7	2.0MW
FL-NCF28/750V	750	920	100	2720	6590	140	2.0MW
FL-NCF28/750V/CNL	750	920	100	2300	6260	140	2.0MW
FL-NCF28/750V/CNH	750	920	100	2300	6260	140	2.0MW
FL-NCF28/800V/HCEC9	800	980	106	2860	7900	168	2.0MW
FL-NCF29/800V	800	1060	150	4770	11450	360	2.0MW
FL-NU2332EMB	160	340	114	1201	1593	49.2	2.3MW
FL-NJ2236EM	180	320	86	1010	1520	30.9	2.3MW
FL-NU2234EMA/C3	170	310	86	973	1430	28.8	2.5MW
FL-NJ236EM/C3	180	320	52	635	870	18.9	2.5MW
FL-NU2236MA/C3H	180	320	86	930	1480	62.2	2.5MW
FL-NUP2340V/C3H	200	420	138	2290	3160	93.1	2.5MW
FL-NU2344M/C3	220	460	145	1880	2830	121	2.5MW
FL-NJ2344V/C3HDF	220	460	290	4420	7070	223	2.5MW
FL-NNCF5044X3V/C3M	220	455	180	3230	4390	138	2.5MW
FL-NUP1064M/C3	320	480	74	910	1490	48.3	2.5MW

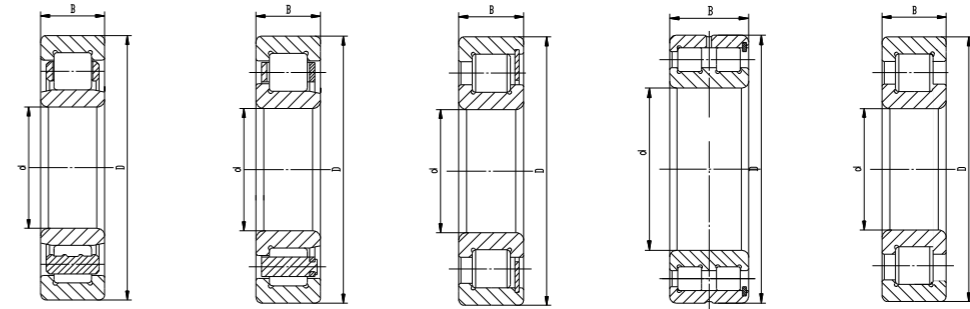

轴承代号 Bearing Designation	外形尺寸 Boundary Dimension			基本额定载荷 Basic load rating		重量 Weight kg	机型 WT
	d	D	B	Cr	Cor		
	mm			kN			
FL-NNU3164V/C3	320	540	176	2990	5860	164	2.5MW
FL-NU1980M/C3	400	540	65	960	1750	41.5	2.5MW
FL-NU2988EM/CNH	440	600	95	1600	3360	81.5	2.5MW
FL-NU2234MA/C3H	170	310	86	840	1320	32	8MW
FL-NU2348M/C3H	240	500	155	2115	3220	152	8MW
FL-NU264M/CNH	320	580	92	1625	2430	113	8MW
FL-NNU30/530V/CNH	530	780	185	4275	9615	300	8MW
FL-NNU30/530V/C3L	530	780	185	4275	9615	300	8MW

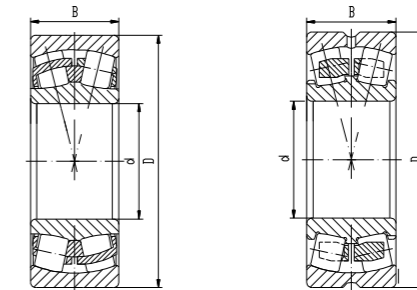

轴承代号 Bearing Designation	外形尺寸 Boundary Dimension			基本额定载荷 Basic load rating		重量 Weight kg	机型 WT
	d	D	B	Cr	Cor		
	mm			kN			
FL-23226C/W33	130	230	80	580	910	14.9	800KW
FL-23232C/W33	160	290	104	1020	1600	36.1	800KW
FL-23134C/W33	170	280	88	870	1450	22.8	800KW
FL-23964C/W33	320	440	90	1219	2650	39.5	800KW
FL-23140C/W33	200	340	112	1340	2240	41.6	1.5MW
FL-22340C/W33	200	420	138	2000	2870	92	1.5MW
FL-23060C/W33	300	460	118	1770	3450	69.5	1.5MW
FL-23072C/W33	360	540	134	2280	4800	124	1.5MW
FL-23240/W33	200	360	128	1490	2370	56.5	2.0MW
FL-22344/W33	220	460	145	2120	3160	122	2.0MW
FL-23068/W33	340	520	133	2070	3870	107	2.0MW
FL-23992/W33	460	620	118	2040	4570	105	2.0MW

增速机轴承 GEARBOX BEARING

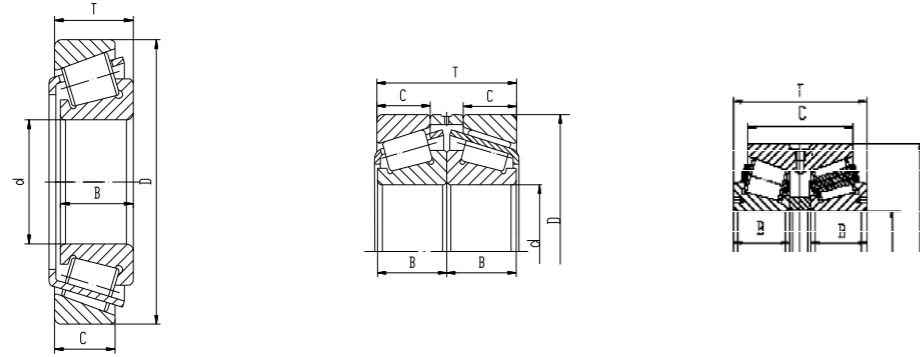

轴承代号 Bearing Designation	外形尺寸 Boundary Dimension					基本额定载荷 Basic load rating		重量 Weight kg	机型 WT
	d	D	B	T	C	Cr	Cor		
	mm					kN			
FL-31328/DF	140	300	70	154	47	1100	1850	50.3	1.5MW
FL-30230	150	270	45	49	38	465	630	10.6	1.5MW
FL-32230	150	270	73	77	60	750	1230	18.4	1.5MW
FL-32234/DF	170	310	73	182	71	1700	3250	62.4	1.5MW
FL-32044	220	340	73	76	57	850	1520	24.2	1.5MW
FL-32244/DF	220	400	73	228	90	2750	5350	130	1.5MW
FL-32948X2A	240	320	73	51	41	395	790	10.8	1.5MW
FL-32056	280	420	73	87	65	1200	2300	40.4	1.5MW
FL-32964X2A	320	440	73	76	62	960	1940	32.1	1.5MW
FL-KHM262749/KMH262710	346.075	488.95	73	95.25	74.612	1420	2900	52.1	1.5MW
FL-32972	360	480	73	76	57	1020	2390	38.5	1.5MW
FL-32972/DF	360	480	73	152	57	1570	4780	79.2	1.5MW
FL-31072X2/DF	360	540	73	172	63.5	2170	4400	123	1.5MW
FL-KM270749/KM270710	447.675	635	73	120.65	95.25	2150	4830	118	1.5MW
FL-KEE649240/K649310	609.6	787.4	73	93.662	69.85	1920	4750	110	1.5MW
FL-KLL481448/KLL481411	673.1	793.75	73	66.675	49.212	1040	2960	52.3	1.5MW
FL-KEE763330/K763410	838.2	1041.4	73	93.662	66.675	2230	5460	158	1.5MW
FL-32956	280	380	63.5	63.5	48	740	1540	20.1	2.0MW
FL-32972/YA5	360	480	76	76	57	1100	2540	37.4	2.0MW
FL-306/500	500	640	80	80	60	1350	3260	60.7	2.0MW
FL-3506/938X4	938.212	1270	169.1	406.2	266.5	9040	29000	1440	2.0MW
FL-KLM770949/KLM770910/DF	457.2	603.25	84.138	171.45	60.325	2300	6470	130	2.0MW
FL-30244+32244/DF	220	400	65/108	186	54/90	2230	4080	104	2.0MW
FL-KLM567949/KLM567910/DF	549.275	406.4	84.138	171.45	61.912	2520	5410	111	2.0MW
FL-30344/DF	220	460	88	194	73	2450	3940	147	2.0MW
FL-KJM272749/KJM272710/DF	479.425	679.45	128.588	257.176	101.6	5080	11500	298	2.0MW
FL-32252/DF	260	480	130	274	105	3740	7360	218	2.0MW
FL-32234/DF	170	310	86	182	86	1723	3230	62.1	2.3MW
FL-32232/YA8	160	290	80	84	67	890	1420	23.5	2.5MW
FL-32232/DFYA8	160	290	80	168	67	1520	2830	48.6	2.5MW
FL-30244	220	400	65	72	54	990	1400	36.8	2.5MW
FL-32048/DF	240	360	76	152	57	1465	3200	53.2	2.5MW
FL-32044/DF	220	340	76	152	57	1460	3050	50	8MW
FL-32248/DF	240	440	120	254	100	3210	6310	169	8MW
FL-30352/DF	260	540	102	226	85	3360	5535	245	8MW

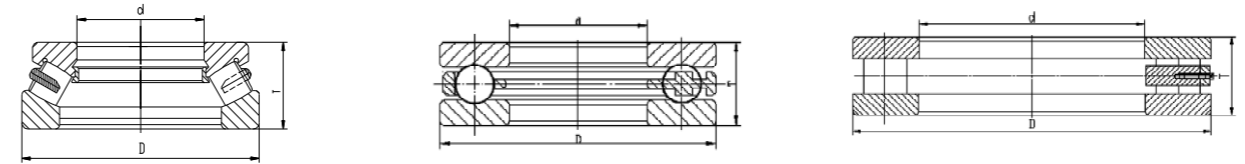

轴承代号 Bearing Designation	外形尺寸 Boundary Dimension			基本额定载荷 Basic load rating		重量 Weight kg	机型 WT
	d	D	T	Cr	Cor		
	mm			kN			
FL-29268	340	460	73	1380	6450	34.7	1.5MW
FL-89415ZW	75	160	51	390	1500	5.95	2.5MW
FL-51334	170	280	87	578	1580	20.3	2.5MW
FL-89436ZW-1	180	360	109	1900	7480	60.3	2.5MW

主轴轴承 ROTOR BEARING

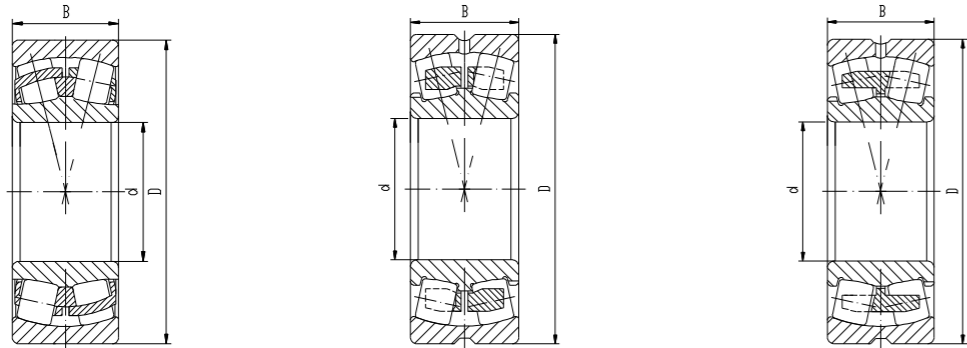

轴承代号 Bearing Designation	外形尺寸 Boundary Dimension			基本额定载荷 Basic load rating		重量 Weight kg	机型 WT
	d	D	B	Cr	Cor		
	mm			kN			
FL-24084/W33	420	620	200	3560	7590	208	750KW
FL-23160C/W33	300	500	160	2710	4900	128	850KW
FL-23064/W33	320	480	121	1870	3560	78.1	850KW
FL-240/560/W33	560	820	258	5950	13500	472	1.0MW
FL-240/530/W33	530	780	250	5300	12100	416	1.5MW
FL-240/600/CNMW33	600	870	272	7690	15900	550	1.5MW
FL-240/630/W33	630	920	290	7350	17100	661	1.5MW
FL-239/670CA/W33	670	900	170	4370	10600	315	1.5MW
FL-230/800/YAD	800	1150	258	9110	19000	899	1.5MW
FL-240/800/W33	800	1150	345	11000	26000	1200	1.5MW
FL-239/800/CA	800	1060	195	5750	14200	481	1.5MW
FL-240/800/W520	800	1150	345	11000	26000	1200	1.5MW
FL-24188/W33	440	720	280	6500	12100	460	2.0MW
FL-240/600/W33	600	870	272	7690	15900	550	2.0MW
FL-240/600/CNHW33	600	870	272	6640	15500	550	2.0MW
FL-230/630CA/W33	630	920	212	5900	12800	473	2.0MW
FL-239/750CA/W33	750	1000	185	5730	12900	414	2.0MW
FL-239/750CA/W33YB1	750	1000	185	5280	12900	414	2.0MW
FL-240/750/W33	750	1090	335	11800	25000	1072	2.0MW
FL-249/750CA/W33	750	1000	250	6580	17900	566	2.0MW
FL-230/750CA/W33	750	1090	250	8060	17900	787	2.0MW
FL-230/800/W33	800	1150	258	9110	19000	904	2.0MW
FL-239/850CA/W33	850	1120	200	6200	15570	541	2.0MW
FL-239/850CA/W33YB1	850	1120	200	6200	15570	541	2.0MW
FL-239/900CA/W33	900	1180	206	6850	16400	616	2.0MW
FL-240/710/W33	710	1030	315	8970	21200	888	3.0MW
FL-240/850CA/W33	850	1220	365	11400	29700	1416	3.0MW
FL-240/900/W26	900	1280	375	11700	32100	1610	3.0MW

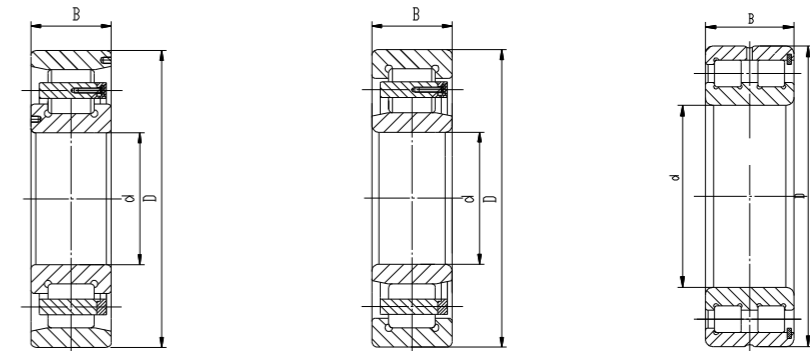

轴承代号 Bearing Designation	外形尺寸 Boundary Dimension			基本额定载荷 Basic load rating		重量 Weight kg	机型 WT
	d	D	B	Cr	Cor		
	mm			kN			
FL-NJ28/710EMA	710	870	95	1970	5080	125	1.5MW
FL-NNU49/710/W33	710	950	243	5080	14400	490	1.5MW
FL-N6/1200/YAD	1200	1520	185	6240	17000	810	1.5MW
FL-NU6/1200	1200	1520	185	6240	17000	832	1.5MW
FL-N18/1600	1600	1950	155	6640	18500	1060	3.0MW

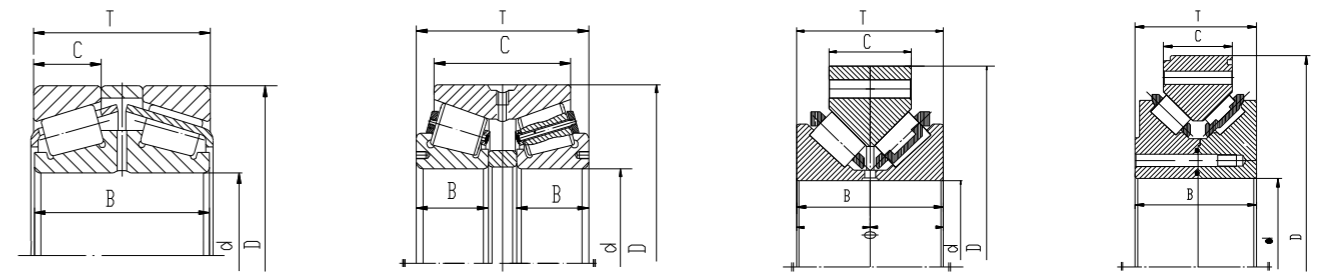

轴承代号 Bearing Designation	外形尺寸 Boundary Dimension					基本额定载荷 Basic load rating		重量 Weight kg	机型 WT
	d	D	B	T	C	Cr	Cor		
	mm					kN			
FL-370692/HC	460	655	212	184	63	2920	7470	209	1.5MW
FL-3706/530	530	730	250	250	104	4600	13400	324	1.5MW
FL-3706/560	560	750	225	225	200	3580	9660	254	1.5MW
FL-3519/710X2	710	950	112	248	180	5000	14400	471	1.5MW
FL-3519/800X2	800	1060	130	285	216	6670	19600	664	1.5MW
FL-3506/1440	1440	1920	143.5	360	210	8430	30360	2475	2.0MW
FL-3506/1810	1810	2530	355	355	202	8260	35500	4804	3.0MW
FL-3506/2000	2000	2500	320	320	180	8020	34600	3130	3.0MW
FL-3506/2620	2620	3200	485	485	250	16460	65880	6720	6.0MW

主轴轴承 ROTOR BEARING

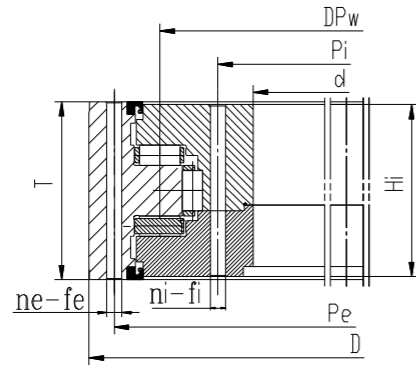

轴承代号 Bearing Designation	外形尺寸 Boundary Dimension					安装尺寸 Mounting Dimension		安装尺寸 Mounting Dimension				重量 Weight	机型 WT
	d	D	H	Hi	Dpw	Pi	Pe	ni	fi	ne	fe		
	mm					mm		mm				kg	
FL-HYB1590FT	1220	1870	352	340	1590	1360	1770	60	30	60	30	3760	2.0MW

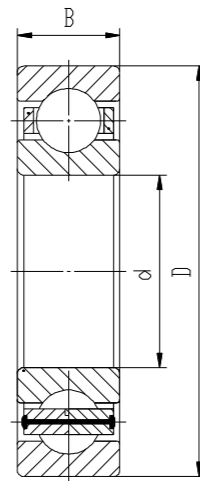

轴承代号 Bearing Designation	外形尺寸 Boundary Dimension			基本额定载荷 Basic load rating		重量 Weight	机型 WT
	d	D	B	Cr	Cor		
	mm			kN		kg	
FL-60/600MA	600	870	118	680	1440	245	100KW

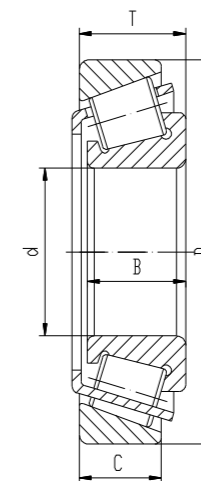

轴承代号 Bearing Designation	外形尺寸 Boundary Dimension					基本额定载荷 Basic load rating		重量 Weight	机型 WT
	d	D	B	T	C	Cr	Cor		
	mm					kN		kg	
FL-306/1270	1270	1630	200	200	150	7200	21900	998	3.0MW
FL-306/1550	1550	1920	200	200	150	7720	24760	1215	3.0MW

驱动减速机轴承 ACTUATOR BEARING

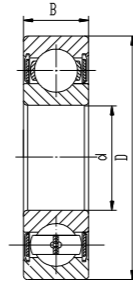
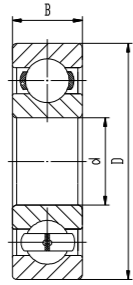

轴承代号 Bearing Designation	外形尺寸 Boundary Dimension			基本额定载荷 Basic load rating		重量 Weight kg	机型 WT
	d	D	B	Cr	Cor		
	mm			kN			
FL-6305	25	62	17	22.4	11.5	0.214	1.5MW
FL-6210	50	90	20	33	21.8	0.474	1.5MW
FL-6012-2RS	60	95	18	25.2	20.1	0.446	1.5MW
FL-6012	60	95	18	25.2	20.1	0.416	1.5MW
FL-6212-2RS	60	110	22	47.8	33	0.8	1.5MW
FL-6215-2RS	75	130	25	61	46	1.22	1.5MW
FL-6015	75	115	20	38	31	0.634	1.5MW
FL-6010	50	80	16	20.8	15.4	0.255	2.0MW
FL-6012/C3	60	95	18	25.2	20.1	0.416	2.0MW
FL-6213	65	120	23	57.2	40.3	1.000	2.0MW
FL-6214	70	125	24	56	41	1.12	2.0MW
FL-6016	80	125	22	42.6	35.5	0.845	3.0MW

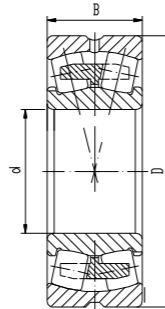
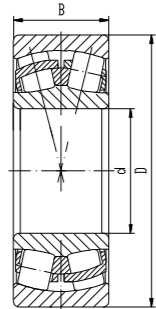

轴承代号 Bearing Designation	外形尺寸 Boundary Dimension			基本额定载荷 Basic load rating		重量 Weight kg	机型 WT
	d	D	B	Cr	Cor		
	mm			kN			
FL-21315CA	75	160	37	236	278	3.89	1.5MW
FL-22316CA	80	170	58	399	500	6.54	1.5MW
FL-24126C/W33	130	210	80	580	980	10.5	1.5MW
FL-23030CA/W33	150	225	56	460	795	7.95	1.5MW
FL-22232CA/W33	160	290	80	860	1270	23.9	1.5MW
FL-23034CA/W33	170	260	67	700	1140	13.9	1.5MW
FL-23032CA/W33	160	240	60	585	880	9.9	2.0MW
FL-22324CA/W33	120	260	86	850	1130	23.2	5.0MW

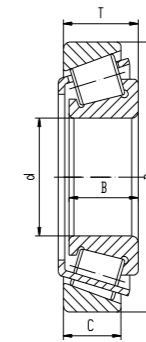

轴承代号 Bearing Designation	外形尺寸 Boundary Dimension					基本额定载荷 Basic load rating		重量 Weight kg	机型 WT
	d	D	B	T	C	Cr	Cor		
	mm					kN			
FL-32910	50	72	15	15	12	38	62	0.194	1.5MW
FL-32912	60	85	17	17	14	40	65	0.284	1.5MW
FL-32012	60	95	23	23	17.5	79	118	0.597	1.5MW
FL-32213	65	120	31	32.75	27	165	215	1.58	1.5MW
FL-30216	80	140	26	28.25	22	163	205	1.56	1.5MW
FL-32217	85	150	36	38.5	30	230	315	2.7	1.5MW
FL-30219	95	170	32	34.5	27	235	300	3.27	1.5MW
FL-33220	100	180	63	63	48	431	655	6.58	1.5MW
FL-T2EE100	100	165	46	47	39	310	480	3.8	1.5MW
FL-32021	105	160	35	35	26	200	324	2.38	1.5MW
FL-32221	105	190	50	53	43	395	572	6.26	1.5MW
FL-33221	105	190	68	68	52	495	764	8.16	1.5MW
FL-33122	110	180	56	56	43	350	610	5.5	1.5MW
FL-30222	110	200	38	41	32	325	435	5.16	1.5MW
FL-30322	110	240	50	54.5	42	485	597	11.1	1.5MW
FL-32024	120	180	38	38	29	237	395	3.27	1.5MW
FL-32026	130	200	45	45	34	340	580	5.06	1.5MW
FL-32028	140	210	45	45	34	330	580	5.41	1.5MW
FL-32228	140	250	68	71.75	58	670	1035	14.7	1.5MW
FL-33030	150	225	59	59	46	450	840	8.06	1.5MW
FL-32232	160	290	80	84	67	910	1450	23.7	1.5MW
FL-32232/YA8	160	290	80	84	67	880	1400	23.5	1.5MW
FL-32240	200	360	98	104	82	1370	2170	42.6	1.5MW
FL-33117	85	140	41	41	32	214	354	2.43	2.0MW
FL-30217	85	150	28	30.5	24	184	234	2.05	2.0MW
FL-30218	90	160	30	32.5	26	222	291	2.73	2.0MW
FL-32219	95	170	43	45.5	37	298	415	4.34	2.0MW
FL-30319	95	200	45	49.5	38	380	468	6.91	2.0MW
FL-32020	100	150	32	32	24	172	280	1.87	2.0MW
FL-32220	100	180	46	49	39	370	540	5.31	2.0MW
FL-30221	105	190	36	39	30	295	390	4.38	2.0MW
FL-33022	110	170	47	47	37	275	465	3.75	2.0MW
FL-33124	120	200	62	62	48	440	770	7.74	2.0MW
FL-32030	150	225	48	48	36	365	635	6.4	2.0MW
FL-32230	150	270	73	77	60	750	1230	18.4	2.0MW
FL-32032	160	240	51	51	38	420	760	7.7	2.0MW
FL-32034	170	260	57	57	43	500	870	10.6	2.0MW

驱动减速机轴承 ACTUATOR BEARING

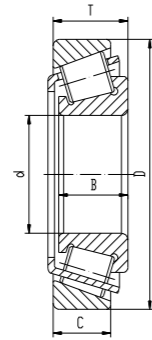

轴承代号 Bearing Designation	外形尺寸 Boundary Dimension					基本额定载荷 Basic load rating		重量 Weight	机型 WT
	d	D	B	T	C	Cr	Cor		
	mm					kN		kg	
FL-32038	190	290	64	64	48	628	1121	14.5	2.0MW
FL-32222	110	200	53	56	46	445	655	7.4	3.0MW
FL-32224	120	215	58	61.5	50	495	750	9.25	3.0MW
FL-30228	140	250	42	45.75	36	428	578	8.8	3.0MW
FL-32234	170	310	86	91	71	1005	1615	30	3.0MW
FL-32236	180	320	86	91	71	1040	1700	30	3.0MW
FL-32238	190	340	92	97	75	1170	1890	36.1	3.0MW
FL-32248	240	440	120	127	100	1900	3200	81.4	3.0MW
FL-32226	130	230	64	67.75	54	572	880	11.5	6.0MW
FL-32036	180	280	64	64	48	605	1060	13.9	6.0MW
FL-32244	220	400	108	114	90	1600	2670	62.7	6.0MW

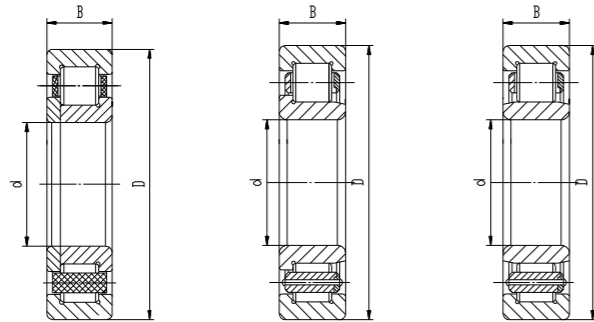

轴承代号 Bearing Designation	外形尺寸 Boundary Dimension			基本额定载荷 Basic load rating		重量 Weight	机型 WT
	d	D	B	Cr	Cor		
	mm			kN		kg	
FL-NUP203ETN1	17	40	12	17.4	14.4	0.0706	1.5MW
FL-NUP205ETN1	25	52	15	32	31	0.14	1.5MW
FL-NU1032M	160	240	38	224	354	6.32	1.5MW
FL-NUP204ETN1	20	47	14	28.2	25.5	0.113	2.0MW
FL-NUP2206ETN1	30	62	20	52	54	0.263	2.0MW
FL-NJ2228M	140	250	68	480	700	14.8	3.0MW
FL-NU2322EM	110	240	80	684	897	18.6	5.0MW
FL-NJ2240EMA	200	360	98	1240	1900	46.7	5.0MW

发电机轴承 BEARINGS FOR GENERATORS

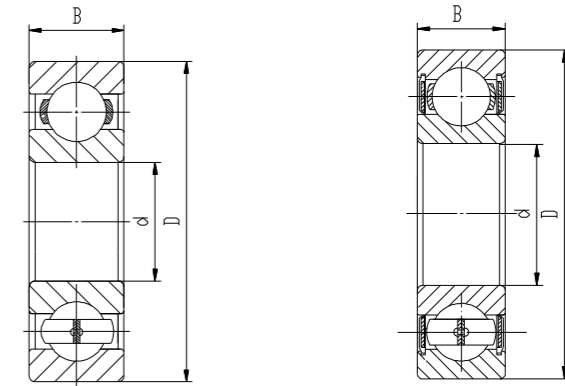

轴承代号 Bearing Designation	外形尺寸 Boundary Dimension			基本额定载荷 Basic load rating		极限转速 Speed limit		重量 Weight	机型 WT
	d	D	B	Cr	Cor	脂润滑	油润滑		
	mm			kN		r/min		kg	
FL-6326/HQ1	130	280	58	240	226	2600	3200	13.5	1.5MW
FL-6328/HQ1	140	300	62	329	246	2400	3000	16.7	1.5MW
FL-6330/HQ1	150	320	65	360	280	2200	2800	18.3	1.5MW
FL-6330M/C4	150	320	65	277	280	2200	2800	24.6	2.0MW
FL-6330M/C3H	150	320	65	277	280	2200	2800	24.6	2.0MW

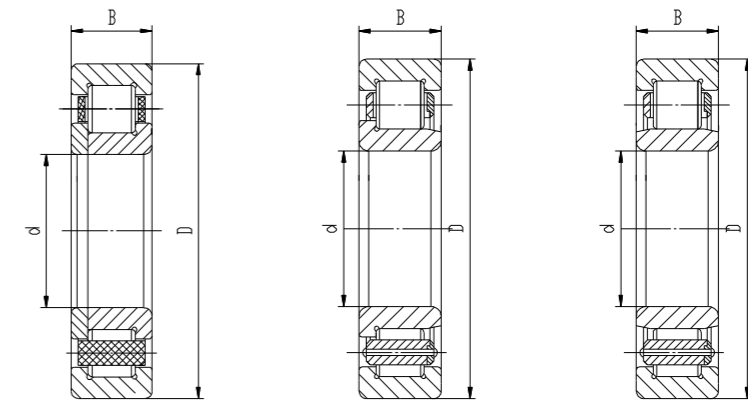

轴承代号 Bearing Designation	外形尺寸 Boundary Dimension			基本额定载荷 Basic load rating		极限转速 Speed limit		重量 Weight	机型 WT
	d	D	B	Cr	Cor	脂润滑	油润滑		
	mm			kN		r/min		kg	
FL-IS-N317EM	85	180	41	271	208	3000	3600	5.2	1.5MW
FL-IS-NU230M/C3	150	270	45	405	550	1900	2400	11.8	1.5MW
FL-IS-NU2230EM	150	270	73	590	890	1900	2400	18.5	1.5MW
FL-IS-N234EM	170	310	52	500	780	1800	2200	18.2	1.5MW